

# 18164 Powder Wheeled Fire Extinguisher kg 50

Approved EN 1866-1:2008 nr. 1207-2009, highest rate achieved - A IVB C



Organic solid materials,  
wood rubber, textiles etc.



Flammable liquids,  
gasoline, oil etc.



Flammable gases,  
methane, propane.

## According to EN 1866-1 and CE-mark

The wheeled fire extinguisher is manufactured according to EN1866-1 and Directive 2014/68/UE. The a.b.s. wheeled extinguisher range is one of the first in Europe to comply with this standard.

## Technical Characteristics

Wheeled extinguisher is designed for professional use under severe circumstances, resulting in a high level of quality and ease of use. The cylinder, CE marked, has the welded frame. Ease of mobility is achieved as a result of the large wheels with solid rubber tyres and push bar also ensuring good stability during operation.

## Cylinder

The design cylinder is manufactured according to EN1866-2 and the Pressure Equipment Directive PED. The cylinder is designed with maximum allowable pressure PS 18bar at 60°C. Each cylinder is leakages tested moreover hydraulic tested up to 30bar for thirty seconds. Before painting it is cleaned with a deep sand blasting assuring a raw surface for a perfect and strong grasp of the epoxy polyester powder coating red RAL 3000 u.v.

## 2" Valve

The valve is made of nickel plated brass and certified according to PED directive. There is a safety device set at 24 bar. There is a green safety seal to improve the optical check from far. Only a simple glance is enough to check if the extinguisher has been tampered.

## Pressure gauge

Pressure gauge is made of nickel plated brass with thread M10x1 with o-ring for easy unscrew to check the real internal pressure any time without need of tools. If the indicator is in the green field, the extinguisher is ready to be used. If the indicator is in the red field, call immediately the authorized service staff.

## Discharge device

Equipped with a highly flexible hose made in EPDM rubber with an excellent resistance manufactured from selected synthetic materials complete with a pistol. The specially designed ergonomic patented pistol ensures a steady flow of powder with a very low drop in pressure.

## Extinguishing agent

Dry chemical powder is manufactured in Europe and its certified according to EN 615. The basic components of dry powder are ammonium phosphate and ammonium sulphate with special silicone additives enabling easy discharge and avoiding any caking process. Dry powder is non-corrosive, non-abrasive, and is non toxic for humans and animals.

Permanent stored pressure



**Swivel coupling**  
It allows easy unrolling of the hose avoiding twisting



**ON REQUEST**

Cod. 21038\_2



## Advantages

- Very mobile and easy to operate
- Excellent quality, therefore a long operational lifetime
- Good ergonomoy, easy to drive
- Extremely high ratings on A, B and C class fires (solid combustibles, liquid fuels and gases)
- Can be used at low temperatures (-30 °C)
- Easy to service
- With CE approval

## - Test method and result -

The 233B tray has been used and four 21B trays have been installed alongside, as from the following design.

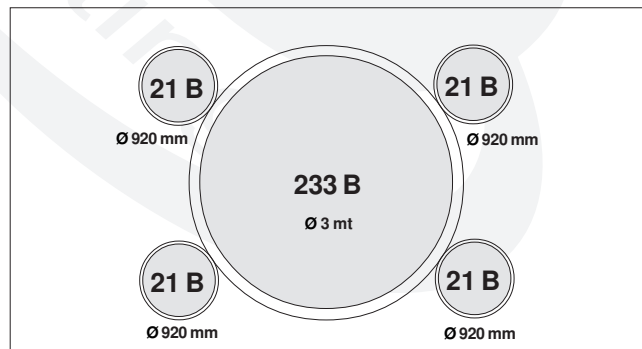

The propellant used has been heptane. The test result was positive.

Classification obtained: **A IVB C**

**Technical specifications**

Cylinder "Ø" ..... : **300 mm**  
 Material ..... : **DD12 UNI EN 10111**  
 Operating pressure ..... : **14 bar at 20°C**  
 Test pressure according PED ..... : **30 bar**  
 Burst pressure ..... : **>55 bar**  
 Temperature range ..... : **-30°C +60°C**  
 Extinguishing agent ..... : **Powder MAP ABC 30**  
 Propellant ..... : **nitrogen or dry air**

Nominal charge ..... : **50 Kg**  
 Discharge time ~ ..... : **43 sec**

**Dimensions**

Height ~ ..... : **1050 mm**  
 Width ~ ..... : **450 mm**  
 Depth ~ ..... : **550 mm**  
 Weight ~ ..... : **80 kg**

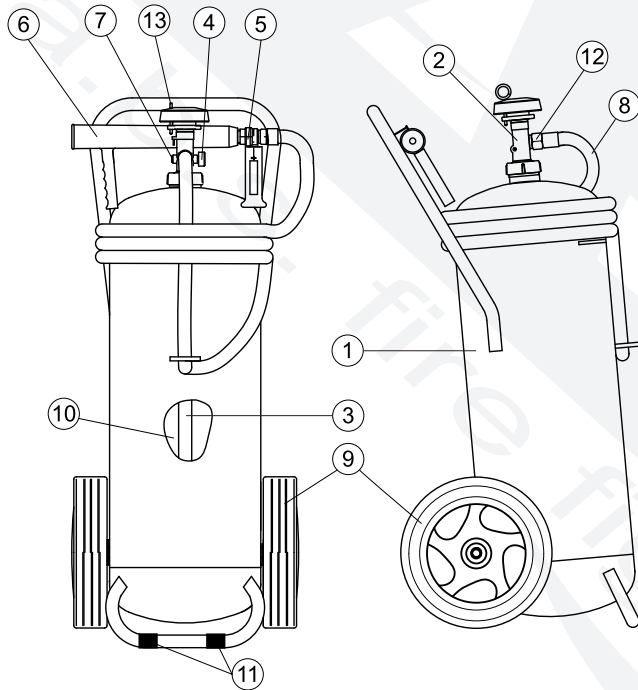

**Spare part list**

Pos.	Description	Code	Q.ty
1	Cylinder (54 lt) <b>on request Stainless steel</b>	27804_V	1
2	Valve brass	21820	1
3	Siphon tube PVC	21715	1
4	Manometer M10x1 Ø 27 mm brass	20532	1
5	Turning valve brass 3/4"	66030	1
6	Discharge horn	21038	1
7	Safety device (in 3 pieces)	21083	1
8	Discharge hose L 5 mt	20649	1
	<b>On request hose L 10 mt</b>	20649_1	
9	Wheel Ø 300 mm	21931	2
10	Powder ABC MAP 30%	31230	50
11	Cap for protection foot cylinder	28072	2
12	Washer ring fibre 3/4" - 15,2x24x2	20021	1
13	Safety pin	21089	1

**Detachable frame**  
 No welding on the cylinder ensure better and higher safety.



**Welded frame.**  
 The axe and carrying handle are welded on the cylinder body.



**The family 18164 include more than one type of version.**  
**18164\_1 - Detachable frame**

The use of non original spare parts may cause malfunctions loss

**Maintenance and Guarantee**

Maintenance must be made periodically by, trained and certified staff, according to the local regulations of the country where it is located. The extinguisher is guaranteed for 12 months from the date of the supply. The guarantee includes, repairing or replacement, as manufacturer option. Unit must be sent back to the factory free of charge, only when authorized written agreement with our sales office has been reached. The guarantee expires in case of tampering and bad maintenance made by not-authorized staff, or transport damages. It must be recharged only by staff authorized and certified by **a.b.s. S.r.l.**, use only genuine original spare parts.



**Technical data are subject to modification for improvements without prior notice**

Data Sheet	Code	Date	Check	Rev	Pag.
Fire Extinguisher	18164	24/01/18	JC	2/AL	2/2